

Area a basso rischio "C" frequenza settimanale 6 g./set.		Mq 981,15
Area a medio rischio "B" frequenza settimanale 7 g./set. con ripasso pomeridiano		Mq 1355,11
Area ad assenza di rischio "D" frequenza settimanale 1 g./set.		Mq 187,60
Area ad alto rischio "A" frequenza settimanale 7 g./set. con ripasso pomeridiano		Mq 1213,13

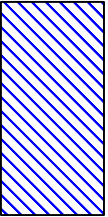
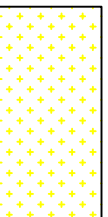
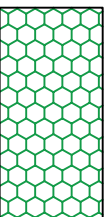
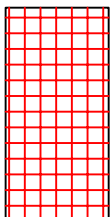
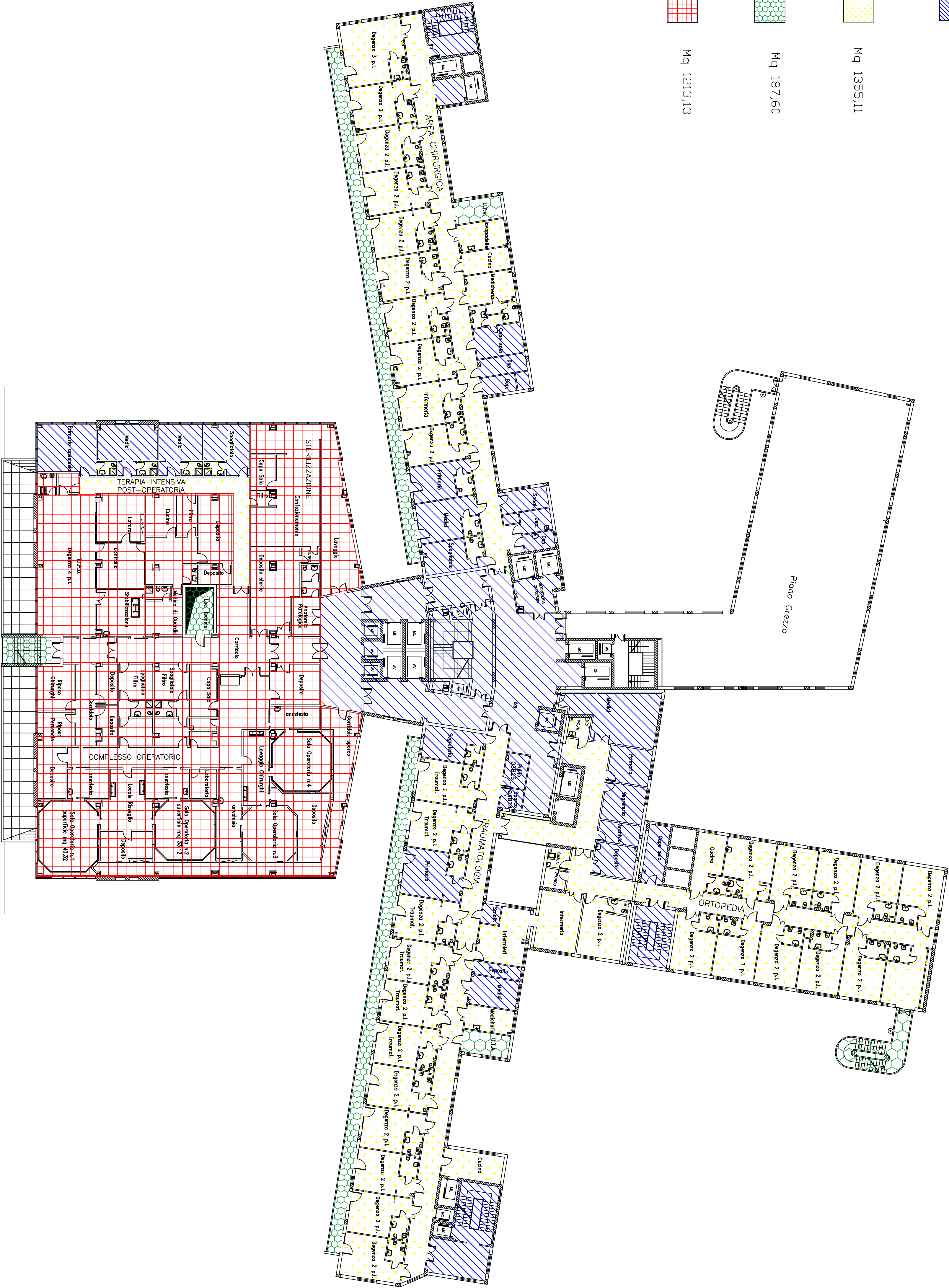

Pianta Terzo - Planimetria classificazione Aree e Frequenza